

A man with short brown hair and black-rimmed glasses is looking slightly to his right. He is wearing a white dress shirt, a teal tie, and a grey tweed jacket. The background is a solid orange color.

Perceptive Pixel by Microsoft

82" Touch Device mounting quick guide

Perceptive Pixel by Microsoft

This document describes how to wall mount the Perceptive Pixel (PPI) by Microsoft 82" Touch Device. This document assumes that you have unpacked the PPI 82" Touch Device and attached the lifting handles to the exterior frame as detailed in the Perceptive Pixel by Microsoft 82" Touch Device packing and unpacking quick guide.

Safety considerations

Due to the weight of the device, mounting the device to the wall requires four people. Each person should be able to lift 70 lbs. You should have already attached the lifting frames and handles seen in figure 1.

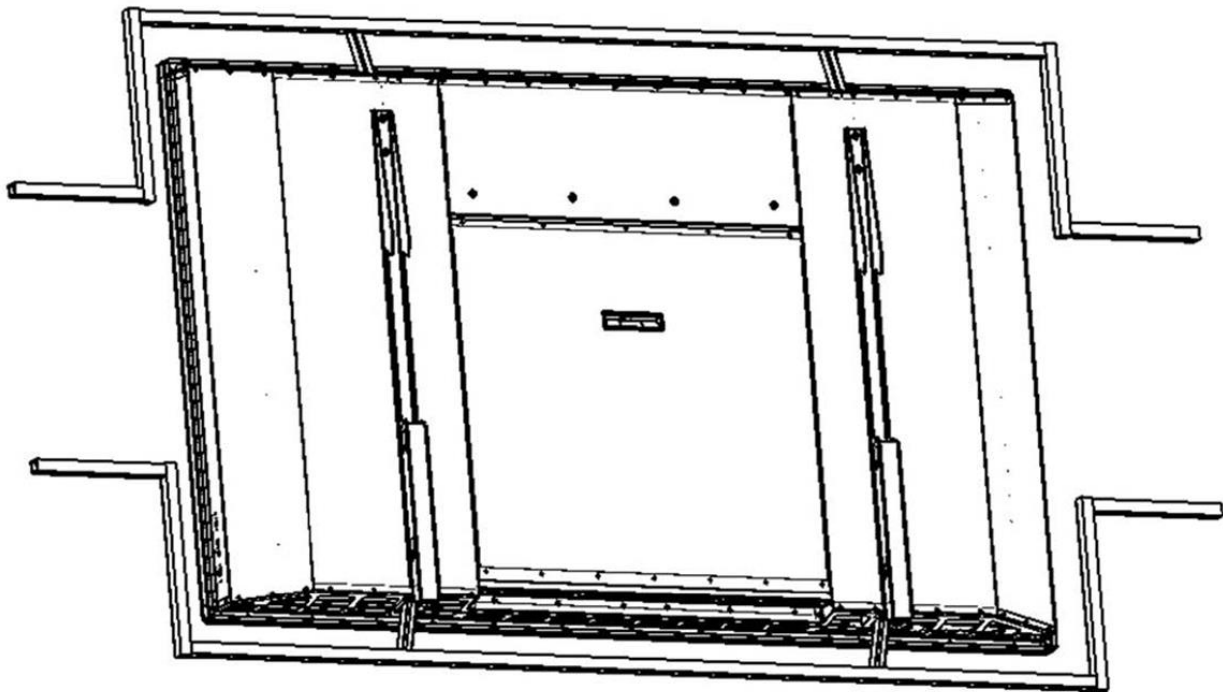

Figure 1. The back of the device with lifting frames attached on top and bottom. Lifting handles are attached to the ends of the lifting frames.

Parts

In addition to the device with lifting handles attached, you will need the following parts to perform this procedure:

- 201-0186: Wall Bracket – see figure 2
- Screws and washers as may be needed depending on wall construction (not shipped)

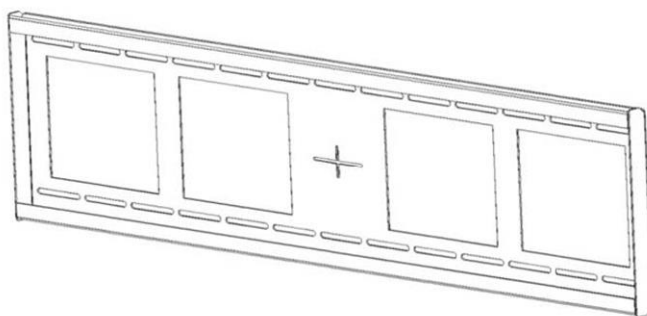

Figure 2. Wall bracket

Tools

You will need the following tools to perform this procedure:

Optional

These tools are likely to be necessary depending on prior accommodations for the wall bracket:

- Pencil
- Level
- Drill
- Screwdriver
- Socket set

Required

The following tool is needed for removing the lift handles and tightening the vertical clamp:

- 5mm hex Allen wrench tool (ideally of the T-handle variety to apply the necessary torque)

Preparation for mounting the PPI 82" Touch Device

Each installation is unique and it is the responsibility of the installer to ensure that the wall bracket location and wall construction are adequate for mounting the device. Microsoft is not responsible for any personal injury or physical damage due to the wall not supporting the installation.

Use the following guidelines when attaching the wall bracket to a wall:

1. Determine if the wall is sturdy enough to support the device. The device plus mounting hardware will weigh up to 280 lbs.

Due to the number of different wall construction methods the PPI 82" Touch Device does not have specific mounting procedures to attach the wall bracket. Therefore the wall bracket must be installed with the sufficiently robust hardware (5/16" or 8mm diameter bolts are generally sufficient, depending on length) and make optimum use of wall studs or equivalent.

2. It is recommended that the center of the bracket be 55" from the floor; measure and mark this dimension. Note that the center of the bracket (the "cross hair" as seen in figure 3) aligns with the vertical center of the device. Also ensure that the wall bracket is level before hanging the device.

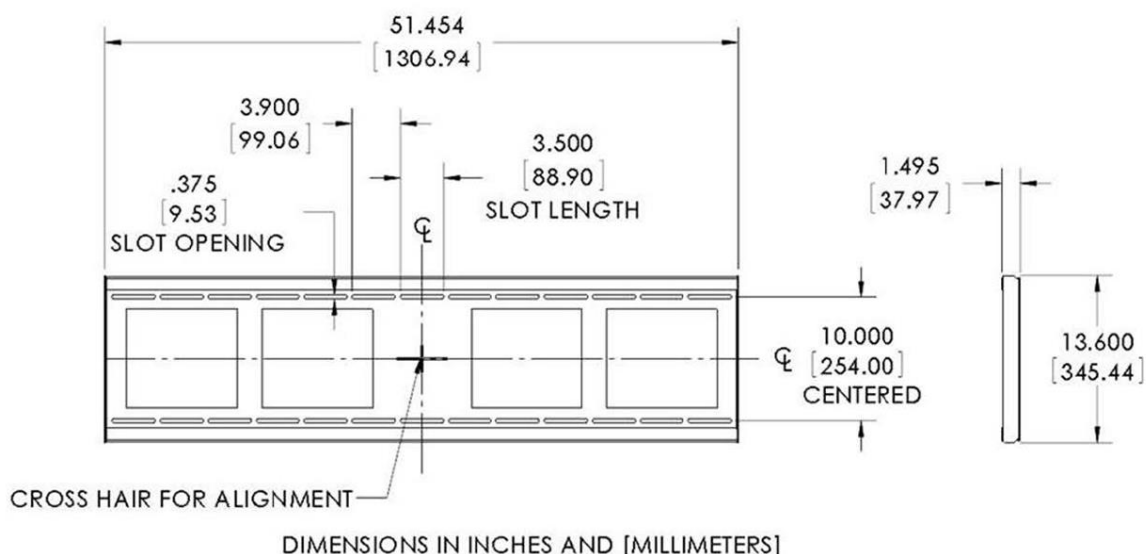

Figure 3. Wall bracket dimensions

Hanging the PPI 82" Touch Device

1. With four able-bodied people, lift the PPI 82" Touch Device using the four lifting handles bolted to the two lifting frames. The device can be tilted slightly to hook the device-mounted vertical brackets onto the wall bracket.

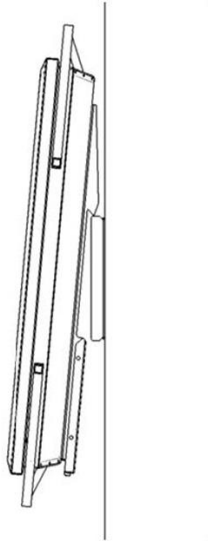

Figure 4. Hooking the top of the device brackets to the wall bracket (side view)

2. Rotate the device to its vertical position. The device's weight will naturally facilitate this. Take care not to pinch fingers.

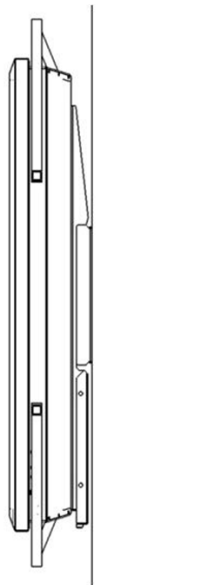

Figure 5. Device rotated to vertical position (side view)

3. Slowly lower the device to allow the brackets to hold the full weight of the device. Continue to hold the lifting handles for several seconds before carefully releasing.
4. If desired, you may move the device left or right approximately 3 inches. You will need to lift the device slightly to do this.
5. For safety it is recommended that two people continue to hold the upper lifting handles. From below, use the 5mm Allen wrench to drive the vertical locking brackets upward to fully engage the wall bracket. Note there is about 1 ¼" of travel for the vertical locking brackets.

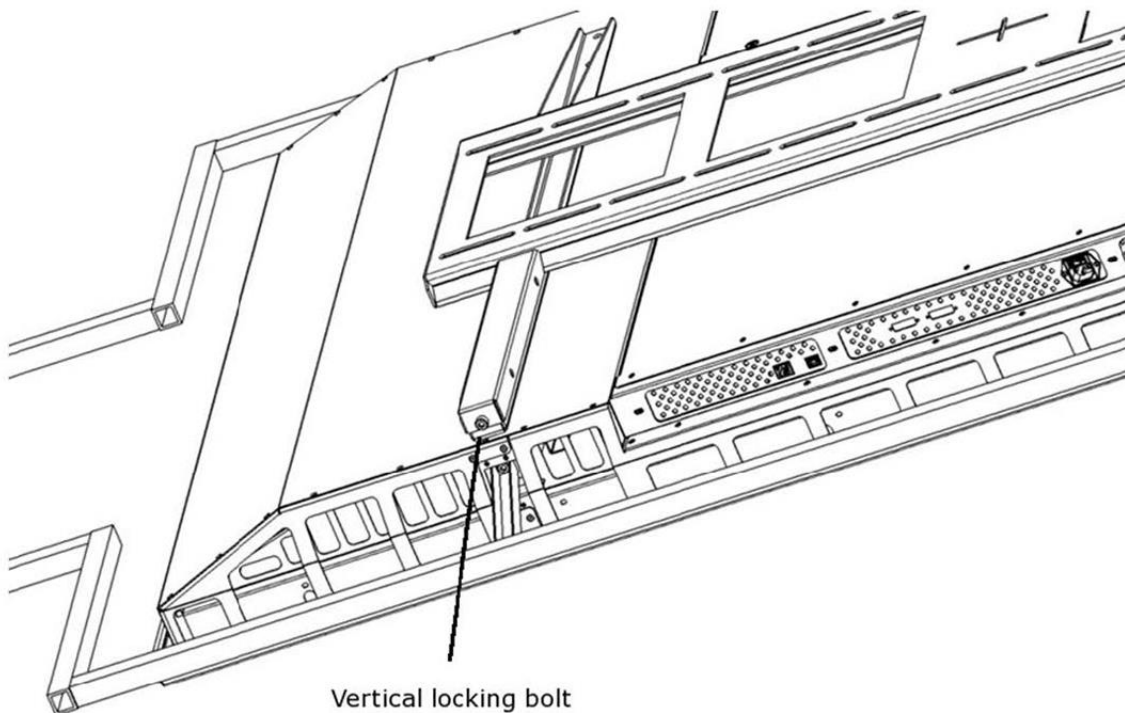

Figure 6. Virtual bottom view of mounted device

6. Remove the lifting handle bolts on both sides to remove the lifting handles. If desired you may also remove the lifting frames from the top and bottom of the device (use extreme care as the lifting frames are unwieldy and heavy). You may wish to use a step ladder to reach the bolts. Use the 5mm Allen wrench for this step.

PPI 82" Touch Device dimensions

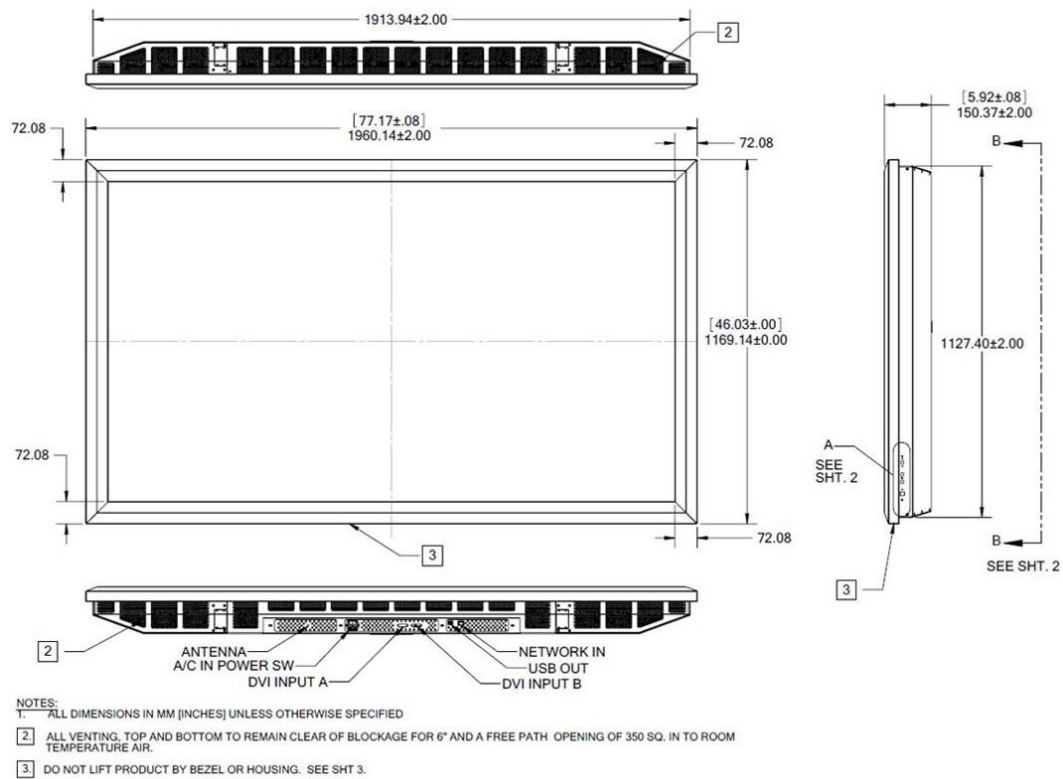

Figure 7. Dimensions of device exterior

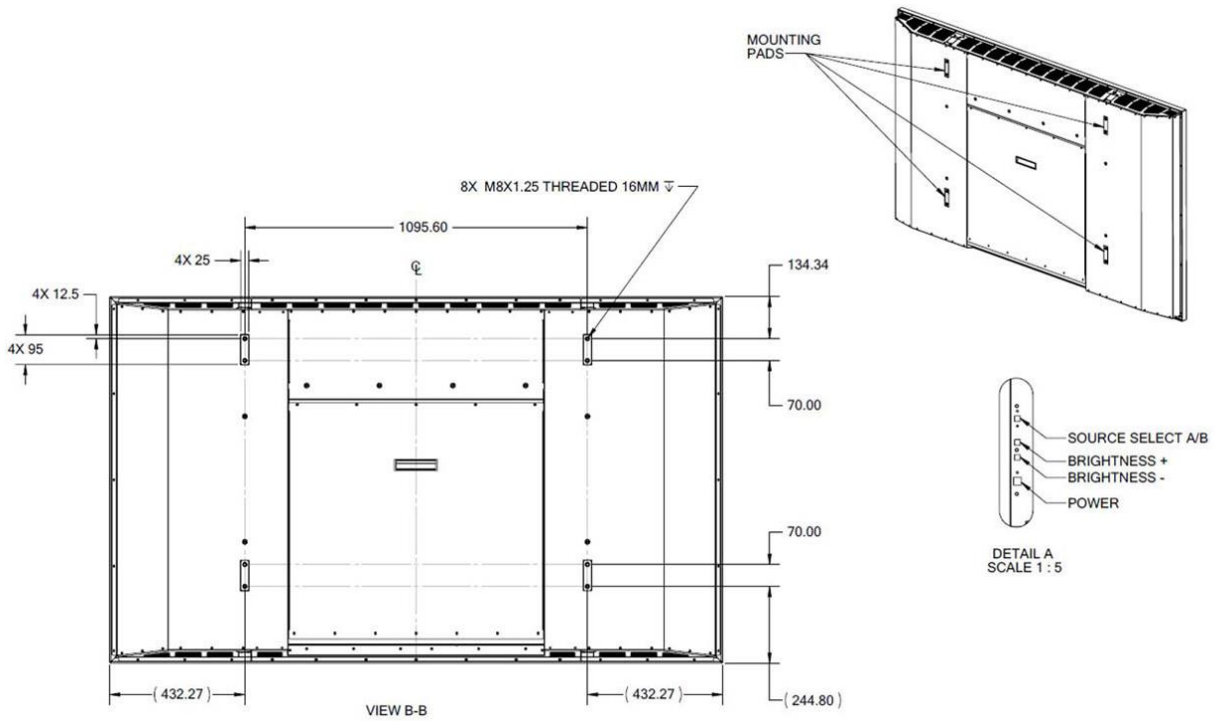

Figure 8. Dimensions of device mounting points

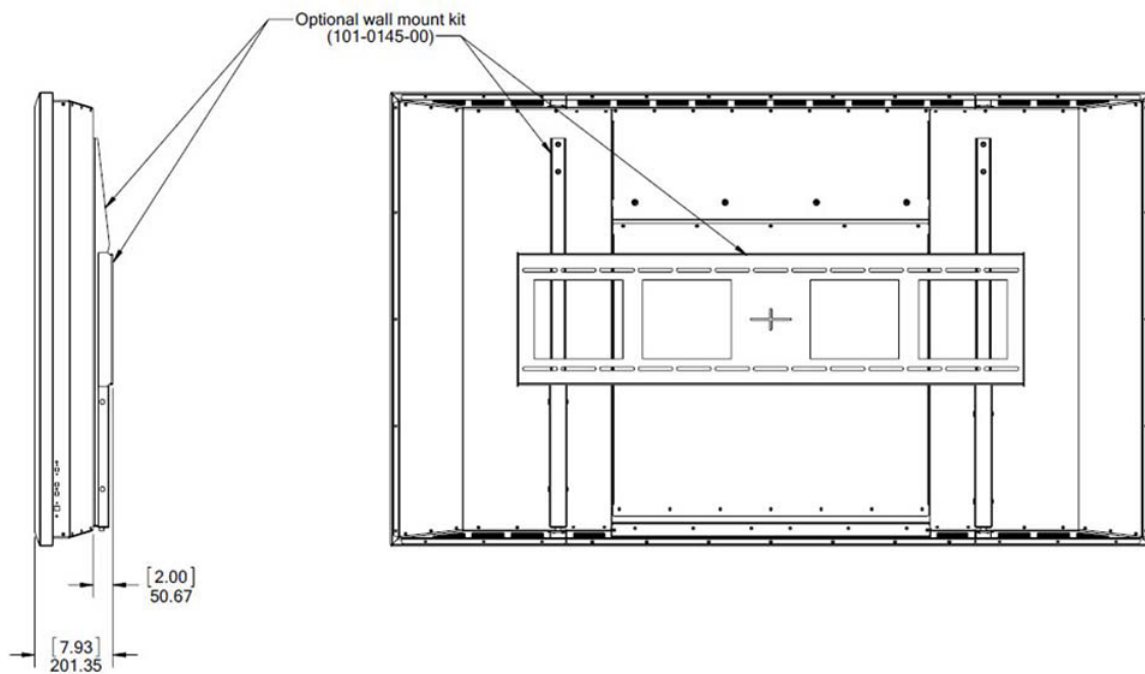

Figure 9. Dimensions of device with wall mount attached

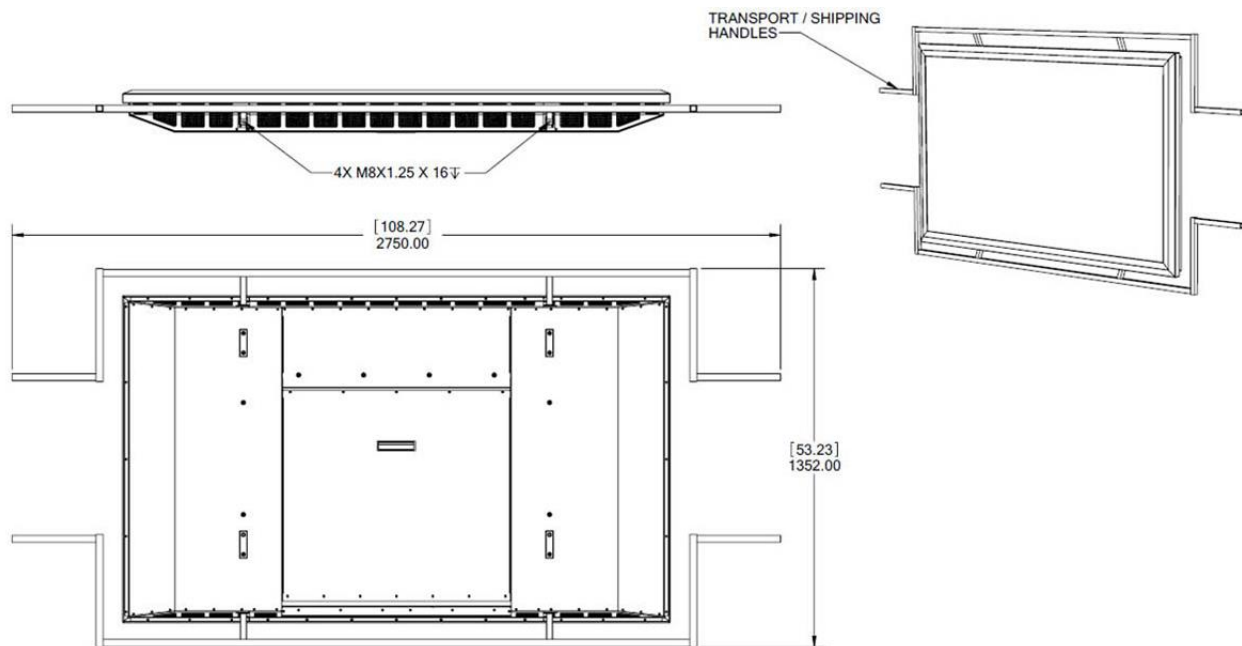

Figure 10. Dimensions of device with lifting handles attached

If you have any questions, you can contact PPI support online via <http://support.microsoft.com/gp/perceptive-pixel> or by calling 1 (800) 642-7676.

Perceptive Pixel by Microsoft

Microsoft